

# ARCHITECTURAL REVIEW REQUEST APPLICATION

## VAQUERO RANCHOS HOMEOWNERS ASSOCIATION

c/o Epic Association Management  
8712 Spanish Ridge Ave., Las Vegas, NV 89148  
Phone/Text: 702.767.9993 \* Email: [general@epicamlv.com](mailto:general@epicamlv.com)

### ARCHITECTURAL SUBMITTAL CHECKLIST:

Property Address: \_\_\_\_\_

Improvement(s) for Review: \_\_\_\_\_  
\_\_\_\_\_

Please complete and submit this application in its entirety. Emailing the application is preferred. Please email the application to the email provided above. If you are mailing the application, we request you mail the original copy and keep a copy for your records. Please contact our office to confirm receipt of your application once submitted.

**ALL APPLICABLE ITEMS ON THE CHECKLIST BELOW ARE REQUIRED TO BE SUBMITTED WITH YOUR APPLICATION. IF AN ITEM IS NOT APPLICABLE TO YOUR IMPROVEMENTS PLEASE MARK IT AS "N/A"**

\_\_\_\_\_ **COLOR PHOTOS MUST BE INCLUDED FOR ALL APPLICABLE IMPROVEMENTS - (Plants/trees/artificial turf, rock samples, paver samples, paint colors, gazebos, sheds, etc.)**

\_\_\_\_\_ All plant life/trees/artificial turf, etc. should be clearly indicated as far as size, type, location on the property, etc. and include set back measurements on the site plans/diagrams as applicable.

\_\_\_\_\_ All decorative rocks, stones, etc. should be clearly indicated as far as size and type along with the color photos.

\_\_\_\_\_ Site Plans/Diagrams/Specifications of Improvements: please submit legible drawings/diagrams/site plans, etc. as they pertain to your improvements. These diagrams are not required to be professionally done. The Architectural Review Committee/Board of Directors just needs to clearly see and understand the proposed improvements. Please be sure to clarify the following items with your diagrams:

- A) Improvement(s) location with measurements/distances in relation to existing structures (residence, property walls, driveway, etc.) as applicable. See attached sample ARC diagram.
- B) Front, rear, and side yard setback measurements as applicable
- C) Measurements of the actual improvement(s) itself. For example, if you are proposing to install a patio cover, we would need to know the specific measurements/size of the patio cover.
- D) Materials list: all building materials required for the improvement(s) should be listed/included with the application. Color samples of applicable materials is recommended.
- E) Drainage pattern(s) for landscaping improvements
- F) Solar panel installation requests should include diagrams showing where the panels will be installed on the roof.

*Return Completed Application to: Epic Assoc. Mgmt., 8712 Spanish Ridge Ave., Las Vegas, NV 89148; [general@epicamlv.com](mailto:general@epicamlv.com)*

## ARCHITECTURAL SUBMITTAL CHECKLIST CONTINUED:

- \_\_\_\_\_ Copy of building/city permit(s) (if applicable). Building/city permits can be submitted after approval from the association if your permit will not be issued until you obtain approval from your association.
- \_\_\_\_\_ Utility connection locations (if applicable)
- \_\_\_\_\_ Building floor plans and roof plans with all dimensions, setbacks, etc. (if applicable)
- \_\_\_\_\_ Manufacturers specifications for improvements (if applicable)
- \_\_\_\_\_ Photograph(s) of similar improvements for reference.
- \_\_\_\_\_ Copy of Business License/Certificate of Insurance if you are using a licensed contractor.

Additional Comments or Details: \_\_\_\_\_  
\_\_\_\_\_  
\_\_\_\_\_

**VAQUERO RANCHOS HOMEOWNERS ASSOCIATION**  
c/o Epic Association Management  
8712 Spanish Ridge Ave., Las Vegas, NV 89148  
Phone/Text: 702.767.9993 \* Email: [general@epicamlv.com](mailto:general@epicamlv.com)

## **ARCHITECTURAL CHANGE REQUEST APPLICATION**

Date: \_\_\_\_\_  
Owner(s) Name: \_\_\_\_\_  
Property Address: \_\_\_\_\_  
Mailing Address (if different from above): \_\_\_\_\_  
Telephone #: \_\_\_\_\_  
Email Address: \_\_\_\_\_

I hereby request approval for the installation of the following improvement(s) to my unit (describe the proposed improvements and provide the required items from the checklist above:

\_\_\_\_\_  
\_\_\_\_\_  
\_\_\_\_\_

**As the homeowner, I understand that I am responsible for any damage(s) done to the common elements during and/or after construction of such improvements.**

Work to be constructed by: \_\_\_\_\_  
Proposed Date of Construction: \_\_\_\_\_  
Proposed Date of Completion: \_\_\_\_\_  
Additional Comments or Details: \_\_\_\_\_

\_\_\_\_\_  
\_\_\_\_\_

Failure to follow these requirements and procedures may cause your request to be delayed pending submission of additional information and documentation to the Architectural Review Committee/Board of Directors. An incomplete application **WILL NOT** be submitted to/reviewed by the Architectural Review Committee/Board of Directors.

**Please be aware that the Architectural Review Committee/Board of Directors may take up to 30 DAYS to approve/deny your application. Please plan for this timeframe accordingly.**

Applicant Signature(s): \_\_\_\_\_

*Return Completed Application to: Epic Assoc. Mgmt., 8712 Spanish Ridge Ave., Las Vegas, NV 89148; [general@epicamlv.com](mailto:general@epicamlv.com)*

**VAQUERO RANCHOS HOMEOWNERS ASSOCIATION**  
c/o Epic Association Management  
8712 Spanish Ridge Ave., Las Vegas, NV 89148  
Phone/Text: 702.767.9993 \* Email: [general@epicamlv.com](mailto:general@epicamlv.com)

**IMPACTED NEIGHBOR STATEMENT**

The impacted neighbor statement page is **required** for all improvements regardless of whether the improvements will directly impact the neighbors or not. This page is intended to make your neighbors aware of your proposed improvements so that they can anticipate the improvements, excess noises, excess visitors to the property, construction, etc. A neighbor's approval/disapproval will be taken into consideration but it is not a direct indication of whether your improvements will be approved or not. Specific objections must be noted or provided separately for the Architectural Review Committee/Board of Directors consideration if a neighbor is recommending disapproval. The Architectural Review Committee/Board of Directors may contact the neighbors to further discuss any objections to proposed improvements.

Name: \_\_\_\_\_

Property Address: \_\_\_\_\_

Improvement for Review: \_\_\_\_\_

On the below noted dates, I/We presented the attached plans and/or drawings to all immediate neighbors for their review of the above noted improvement. Each neighbor has been notified that these drawings and/or plans are being submitted for approval:

Adjacent Neighbor:    \_\_\_\_\_ Approval                      \_\_\_\_\_ Recommended Disapproval\*\*  
Signature: \_\_\_\_\_                                              Address: \_\_\_\_\_  
Telephone: \_\_\_\_\_                                              Date: \_\_\_\_\_

Adjacent Neighbor:    \_\_\_\_\_ Approval                      \_\_\_\_\_ Recommended Disapproval\*\*  
Signature: \_\_\_\_\_                                              Address: \_\_\_\_\_  
Telephone: \_\_\_\_\_                                              Date: \_\_\_\_\_

Adjacent Neighbor:    \_\_\_\_\_ Approval                      \_\_\_\_\_ Recommended Disapproval\*\*  
Signature: \_\_\_\_\_                                              Address: \_\_\_\_\_  
Telephone: \_\_\_\_\_                                              Date: \_\_\_\_\_

Adjacent Neighbor:    \_\_\_\_\_ Approval                      \_\_\_\_\_ Recommended Disapproval\*\*  
Signature: \_\_\_\_\_                                              Address: \_\_\_\_\_  
Telephone: \_\_\_\_\_                                              Date: \_\_\_\_\_

Applicant Signature(s): \_\_\_\_\_

*Return Completed Application to: Epic Assoc. Mgmt., 8712 Spanish Ridge Ave., Las Vegas, NV 89148; [general@epicamlv.com](mailto:general@epicamlv.com)*

# PETA YARD LANDSCAPING

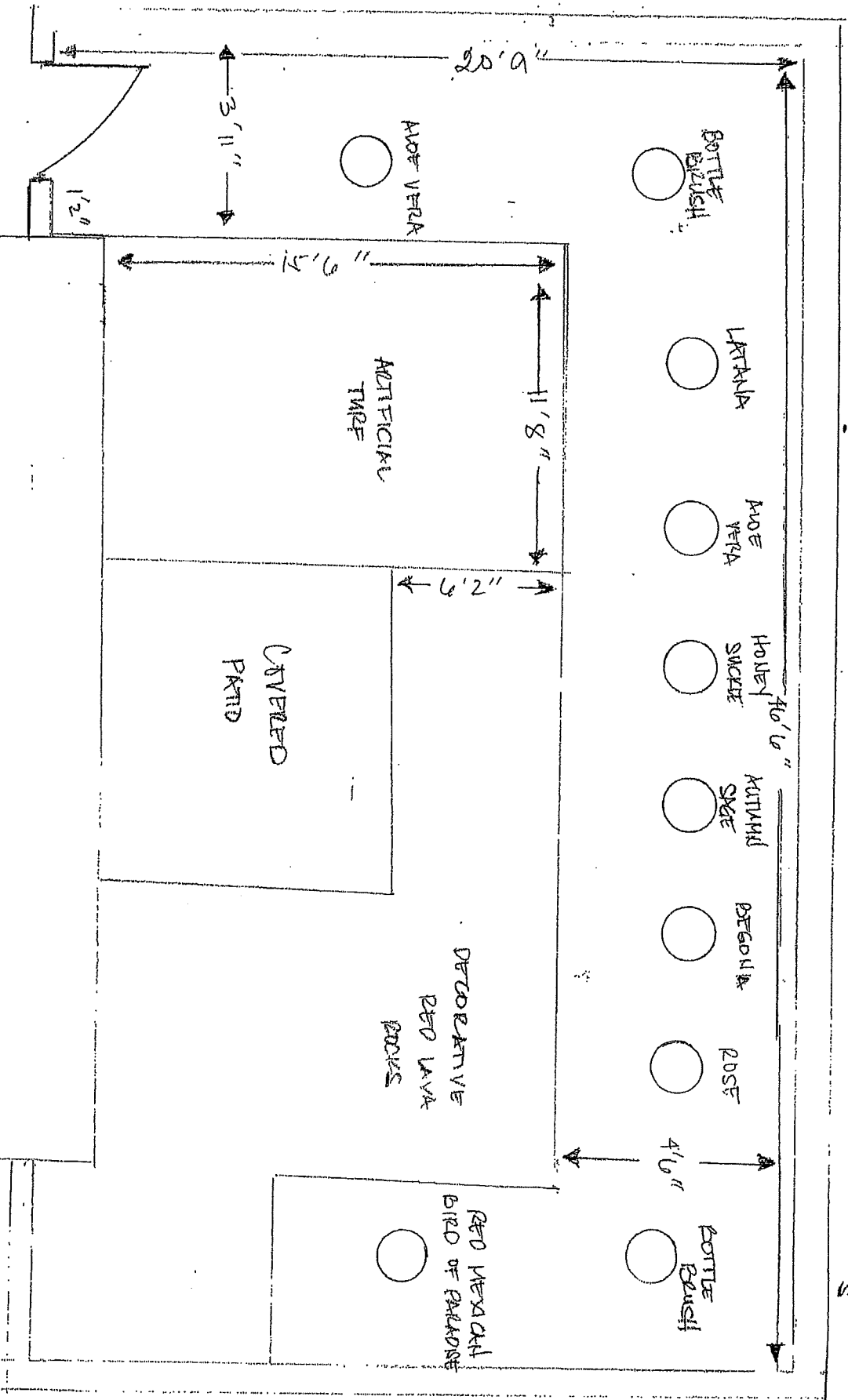
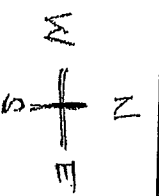

DRAWING / DISSERAM SAMPLE